

# INSTALLING THE BRAKE PADS

1. Position each pad on an opposite side of the holder so that the two braking surfaces are facing each other.
2. Taking care not to touch the braking surfaces, push the pads in the holder together and insert into the caliper so that the protruding lip with the retainer bolt hole is aligned with the bolt hole on the caliper.
3. Insert the retainer bolt and tighten it with a 3mm Allen wrench. Final tightening torque should be 0.8-1.2 Nm.

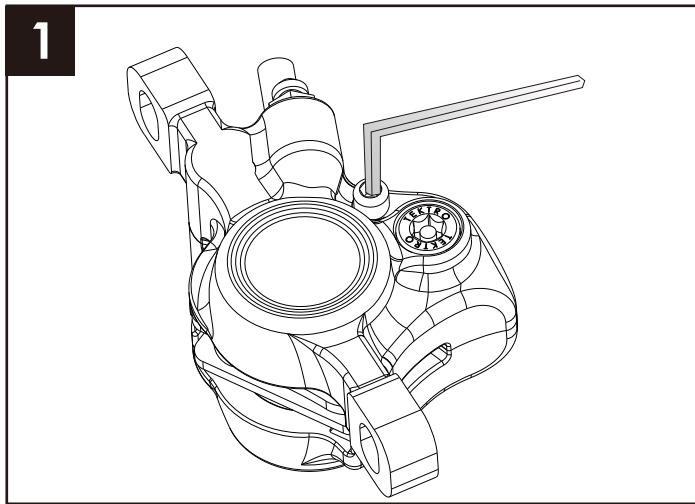

Unscrew pad retainer bolt

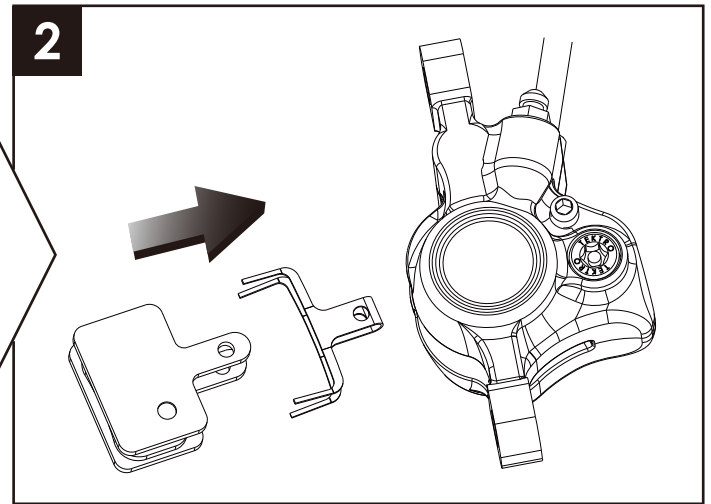

Replace pads and holder

NOTE - New pads require about 20-30 full stops to achieve their optimum braking power. This process is called bedding-in. After bedding-in is complete you may need to readjust the pads.