

INSTALLATION INSTRUCTIONS

LINEAR PULL BRAKES

For linear spring design brakes

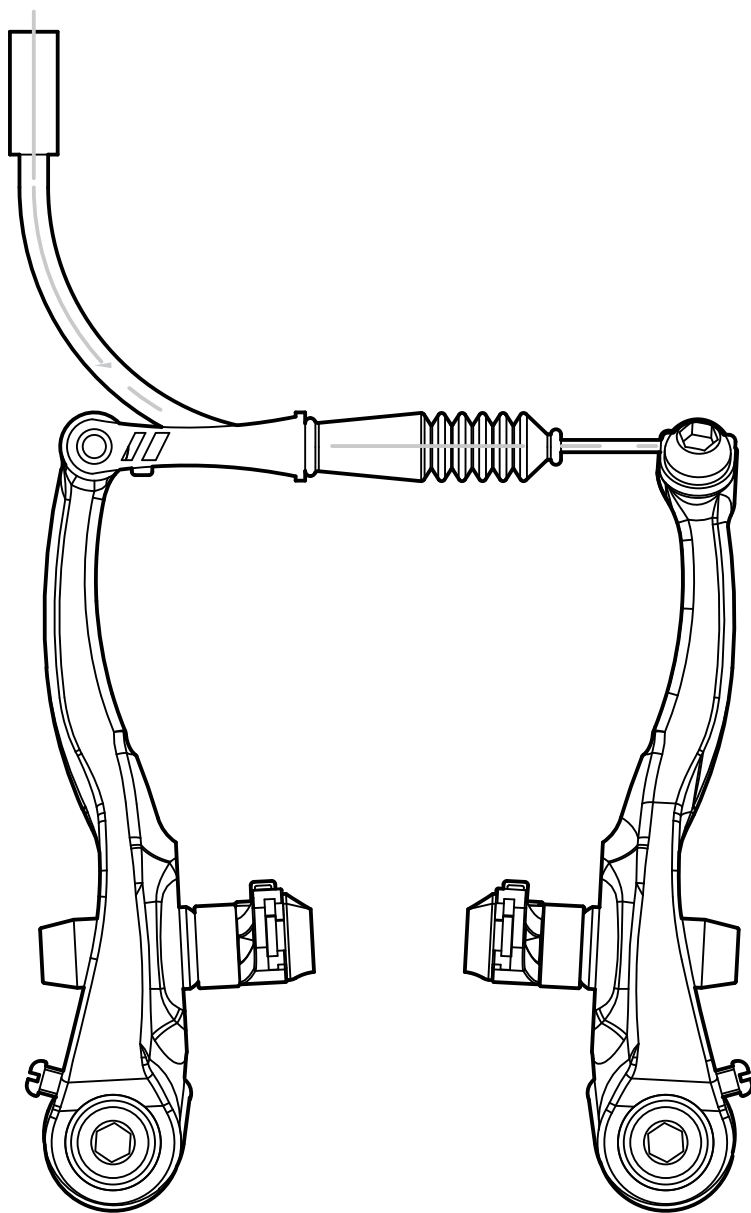

TEKTRO
TEKTRO TECHNOLOGY CORPORATION

[http:// www.tektro.com](http://www.tektro.com)
E-mail: info@tektro.com.tw

Edition-2010, April C1

000907820A

LINEAR PULL BRAKES

For linear spring design brakes

1>Clean and grease fork and stay pivot bosses. Install spring system, brake arm, and mounting bolt onto each pivot. Insert spring-base pin into middle hole of pivot boss. Linear spring should press against linear-spring stops. Please use appropriate mounting bolts: Tekro supplies 2 pairs of bolts, 15mm & 25mm. Many suspension forks require 15mm bolts whereas standard forks should use 25mm bolts. If in doubt, see your suspension fork installation instructions for details. Tighten mounting bolts. **Final tightening torque:8-10Nm.**

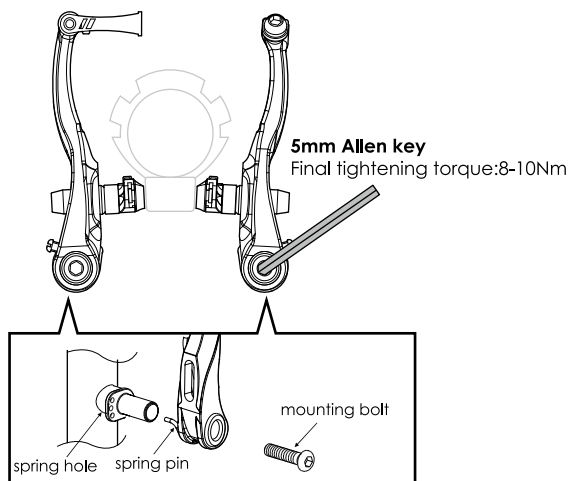

2>With both pads pressed against the wheel rim, ensure that distance-A (in diagram) does not exceed 65mm or 45mm in Mini-V brake. To decrease distance-A, exchange wide and narrow spacers on each brake pad.

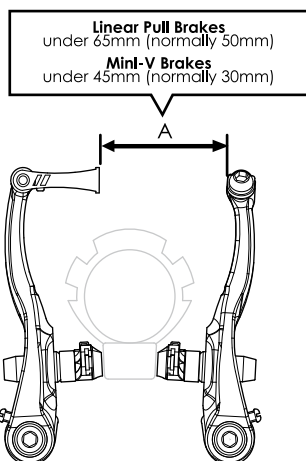

3>Before finally tightening brake pads, make sure they are aligned correctly on the rim, and there is a gap of 1mm between the top of the rim and the top of the pad. Hold each pad against the rim(one at a time) & tighten mounting nut. Final tightening torque: 6-8Nm.

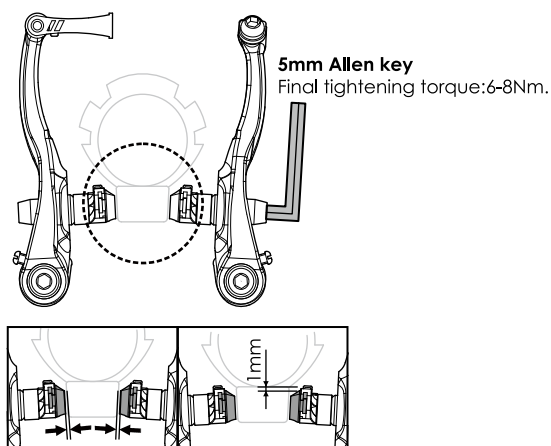

4>Insert cable through cable guide pipe, cable protector and anchor-bolt. Slot cable guide pipe into holder and fit protector over guide pipe end. Set cable in anchor bolt so that combined pad / rim clearance (A+B) is 2mm, then tighten anchor bolt. (If clearance is not 1mm each side, it will be balanced out in step 5). **Final tightening torque 6-8Nm.** Crimp end-cap onto cable end.

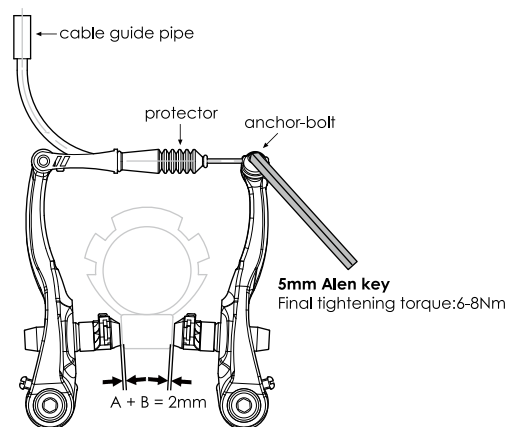

5>Balance brake arms by turning spring-tension adjusters. Depress brake lever a few times while checking to see that tension is equal for both arms. Pad/rim contact should occur at the same time each side. Clearance should be 1mm each side. **Do not see tension too high.**

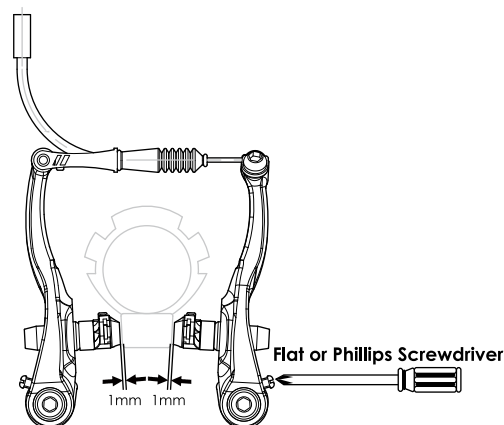

6> Readjust pads so they are properly aligned (see Step3), as tension adjustment will probably have altered original pad alignment.

NOTE

- 1) Cables pass directly from levers, through housing, to cable guide pipes. Use 90° pipe for left-lever/front-brake and right-lever/rear-brake. Use 130° pipe for left-lever/rear-brake and right-lever/front-brake.
- 2) Ensure that brake levers are properly installed.
- 3) Spring-tension adjusters require a 2mm Allen wrench (see Step 5). All other bolts require a 5mm Allen wrench.
- 4) Pad/rim clearance can be further adjusted by turning brake-lever adjusting barrel.

Consult your TEKRO dealer if you are unsure about installation or adjustment.

CAUTION:

TEKRO LINEAR PULL BRAKES MUST BE USED WITH LINEAR PULL BRAKE LEVERS. LINEAR PULL BRAKES OFFER CONSIDERABLE BRAKING POWER WITH LITTLE LEVERAGE FORCE, AND REQUIRE PRACTICE AT LOW SPEEDS BEFORE NORMAL USE. TEKRO IS NOT LIABLE OR DAMAGE OR INJURY AS A RESULT OF IMPROPER INSTALLATION OR USE.